

perma PRO C MP-6

Quick Start Guide



Scan the QR code for a video tutorial.

Assembly

1 | INSERT BATTERY

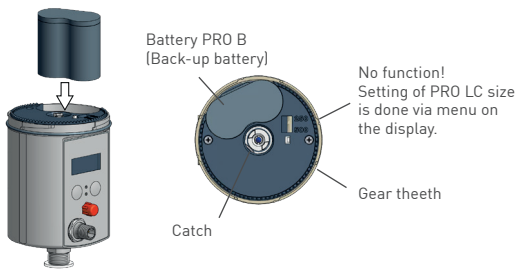

Insert the battery PRO B into the drive unit (according to the direction of the arrow on the label).

2 | COVER FOR PRO LC & PLUG

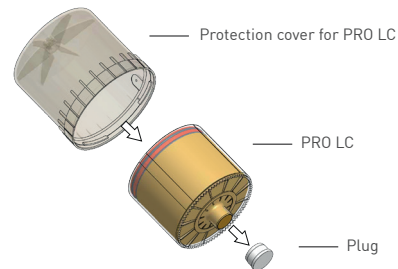

Place the PRO LC inside the protection cover and remove the plug of the PRO LC.

3 | DISCHARGE OPENING

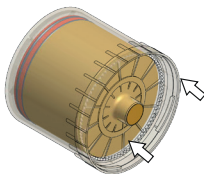

Push the PRO LC into the protection cover until lubricant comes out of the opening.

4 | DRIVE



Place the PRO LC with its protection cover on the drive unit. Turn the cover clockwise until the bayonet catch locks.

Connecting of the connecting cable

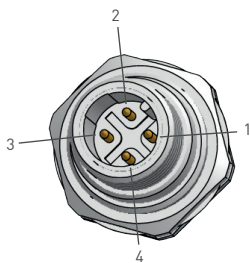

Pin no. of the connector on the lubricator	Strand color of the standard cable	Function
1	brown	Not assigned
2	white	Malfunction*
3	blue	Ground
4	black	Voltage (15 V to 30 V - DC)

*Error signal is low-active! (negative logic)

Connect the four strands of the connecting cable to the control system of your equipment. Pay attention to the pin assignment of the connector on the lubricator. Insulate the connected strands correctly. Insert the 4-pole connecting cable into the connector of the PRO C Drive. Screw tight the connector socket of the connecting cable to the connector of the PRO C Drive.

Display

Configuration menu
For entering the settings.

Outlets 1 - 6
shows activated outlets.

Number
Shows remaining volume, discharge period, outlet no., PIN, and malfunction codes.

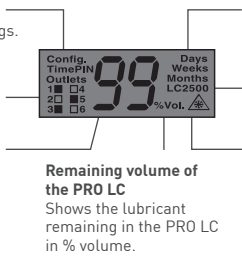

Remaining volume of the PRO LC
Shows the lubricant remaining in the PRO LC in % volume.

Setting mode
Displays the current setting in days, weeks, or months.

Size of PRO LC
Displays volume of PRO LC (250 or 500 cm³).

Ice icon
Indicates either that the temperature fell below 0 °C/32 °F (icon blinking), or that the low temperature shutoff (below -20 °C/-4 °F) has turned the system off (icon permanent).

Control Buttons

Press	Short	Short	Long > 4 sec. until the display content changes completely	Long > 4 sec. until the display content changes completely
Button				
Function	Selection in current display	Changing of values	Moves to new menu and saves selected values	Returns to original menu without saving changes

Settings and Display

	Display		Meaning / Description	
	--		Display at delivery with attached PRO LC	
	Time 06 Months		Shows discharge period PIN-reset	Info
	PIN 00	Change first digit 	Enter first digit of current PIN PIN "00" at delivery	PIN-Entry
	PIN 00	Change second digit 	Enter second digit of current PIN	
	Config. LC LC 500	Change from LC500 to LC250 	Set PRO LC size	LC
	Config. Time 06 Months	Change months 	Set discharge period: Months or Weeks or Days	Time
	Config. Time 01 Weeks	Change days or weeks 	Set discharge period: Go to "Days" or "Weeks"	
	Config. Outlets 1	Outlet 1 On / Off 	Activate outlets: Activate outlet 1 Outlets only displayed if MP-6 is connected	Outlets
	Config. Outlets 2	Outlet 2 On / Off 	Outlet 2 activated (if desired, other outlets may be turned On / Off the same way)	
	Config. PIN 00	Change first digit 	PIN (first digit) enter for initial configuration or after a PIN-reset - otherwise, setting is complete	PIN
	Config. PIN 00	Change second digit 	PIN (second digit) enter for initial configuration or after a PIN-reset	
	--		Configuration finished	

- short push
- long push
- blinking display
- go to

I N T R O
C O N F I G U R A T I O N M E N U

For information on how to determine the discharge period without impulse mode, please see the corresponding table on page 33 of the operating instructions.